

To ensure that your installation proceeds smoothly,  
please read this instructions carefully before you begin.

*American Standard*

FFAS9143-000XXXBF0  
Wall Outlet with Holder – Square (G1/2")  
FFAS9143-000XXXBT0  
Wall Outlet with Holder – Square (R1/2")

XXX = AL0 / A00 / DA0 / GL0 / 440 / 500

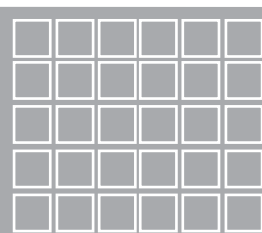
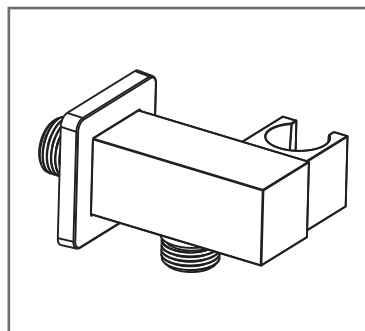

Installation &  
Operation Instruction

## Dimension

FFAS9143-000XXXBF0

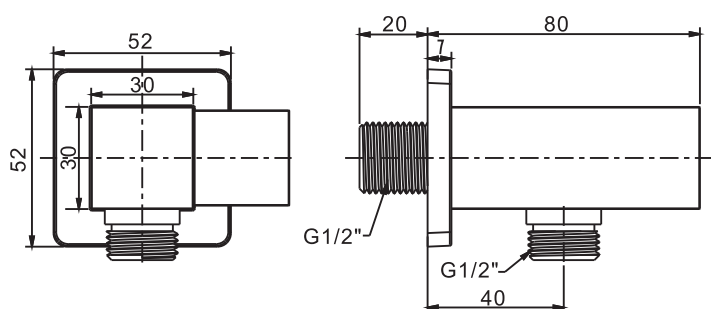

FFAS9143-000XXXBT0

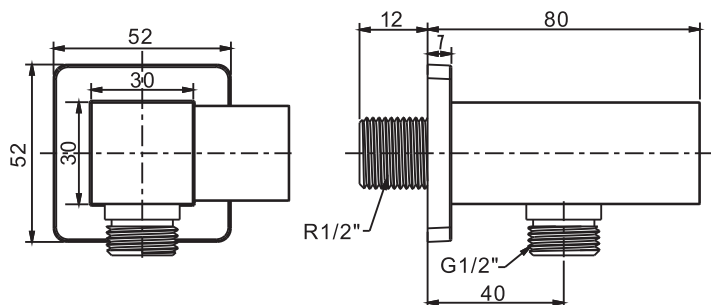

## Installation

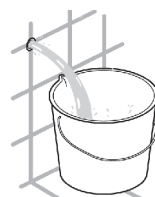

1

- \* Consult the dimension drawing and lay the pipes.
- \* Wash and clean the water supply pipeline.

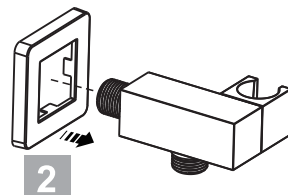

2

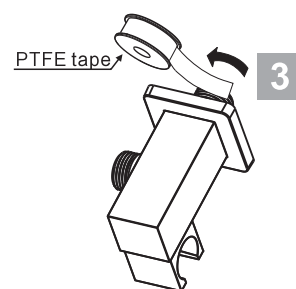

3

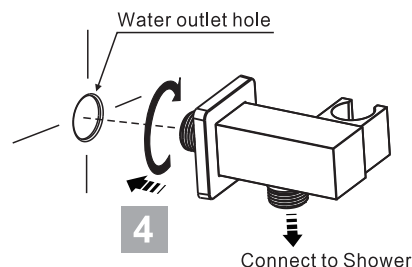

4

Connect to Shower

## Parts List

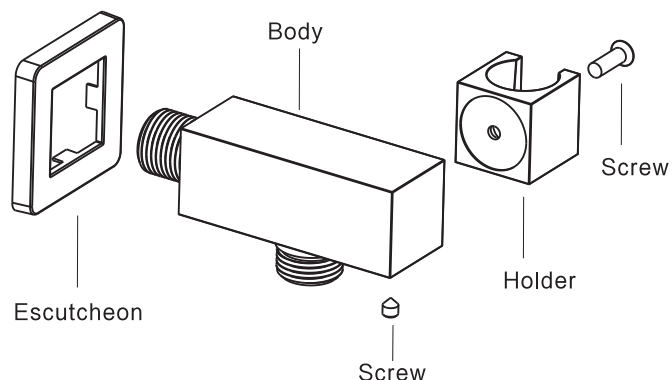

## Notice

Remove all impurity in pipes before beginning to avoid clogging. Connect faucet pipes correctly.

When you repair the faucet you will need to shut off hot/cold water supply by closing the water supply.

### Conditions for use

- \* Water pressure condition: 0.1MPa~0.75MPa (Recommended: 0.1MPa~0.5MPa)
- \* Environment Temperature: 1°C~55°C
- \* Not for use as a steam outlet.

### Cleaning the surface of faucet

- \* Rinse the product with clean water.
- \* Dry with soft cotton flannel cloth.
- \* Do not clean the product with acid, polish, abrasives, harsh cleaners, or cloth with a harsh surface as these products may damage the finish.