

Installation manual

CCAS0420-101
CCAS0420-104
CCAS0420-108

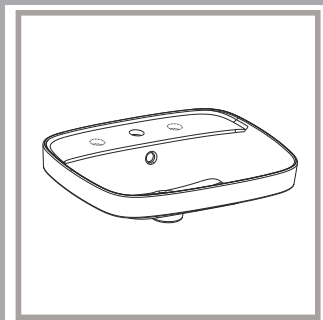

American Standard

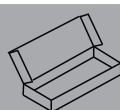
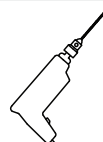
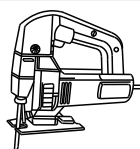
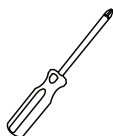
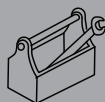
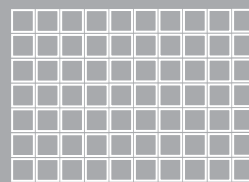

Detail parts

CCAS0420-101

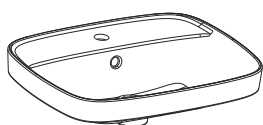

— x1



— x1

CCAS0420-104/108

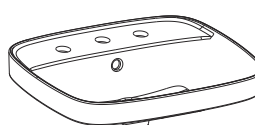

— x1



— x1



Installation drawing

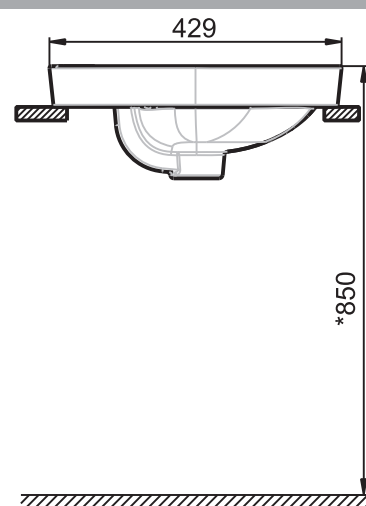
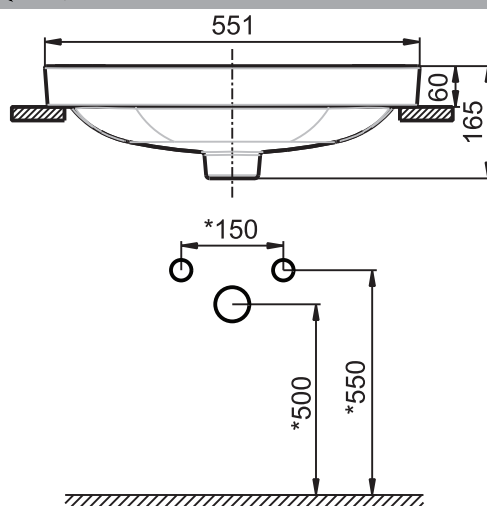
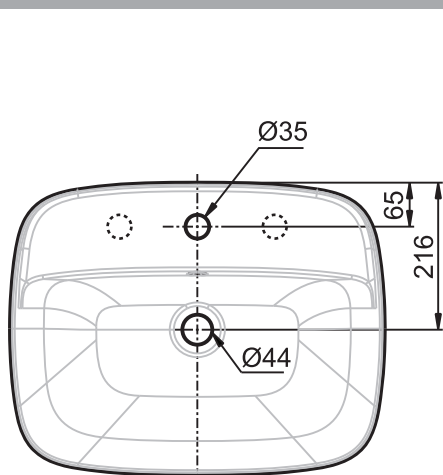

Jan.19
Rev.01



Installation manual

1

PLACE THE TEMPLATE ONTO THE COUNTER

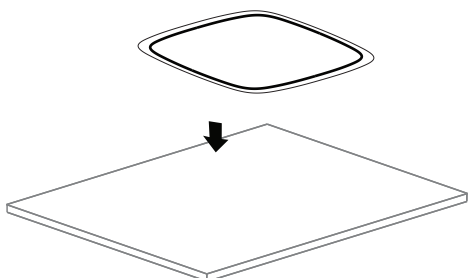

2

TRACE THE PEN ALONG THE TEMPLATE

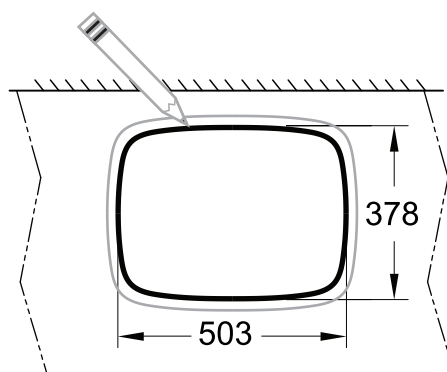

3

CUT THE COUNTER SURFACE ALONG THE LINE

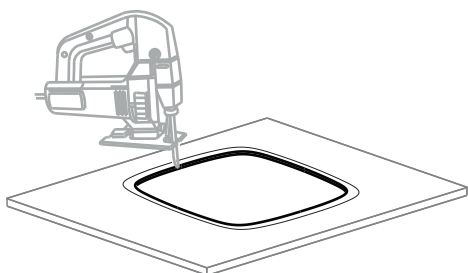

4

PUT THE LAVATORY ONTO THE COUNTER

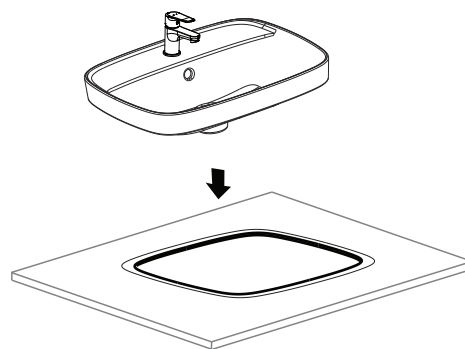

5

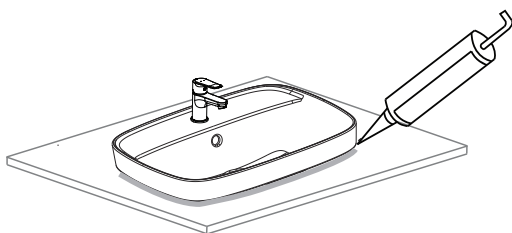

APPLY SILLICON





Safety precautions

- Read the instructions carefully before beginning.
- Cautions and notes below if not complied may lead to serious damage. Therefore, please follow strictly.
- After finishing installation, check out whether the facility operates properly or not.
- If possible, customer should to keep this instruction as reference in the future.

 ATTENTION	
	<ul style="list-style-type: none">※ Before installation, please check the product again for cracks or breaks during delivery※ Be sure to test operation and check for any breaks, cracks after installation has been completed.※ Any cracks may cause injury, damage, leakage or dirty the floor.
	<ul style="list-style-type: none">- Do not overtighten bolts.※ Porcelain is subject to cracking, which may cause injury to installing person or users.

CONDITION OF USE

1. Minimum pressure: 0.07 Mpa or above (Flowing)
2. Maximum pressure: 0.75 Mpa or below (static).

Note: If the water pressure is under minimum requirement, the water flow is not strong enough, which will affect the flushing function.

ALL INSTALLATION PROCEDURES MUST COMPLY IN TRICT ACCORDANCE WITH THE LOCAL PLUMBING AND CODE

CARE AND MAINTENANCE

Do not use harsh abrasives or caustic clean fixture surface. A mild detergent, warm water, and a soft cloth will remove normal dirt and soap accumulations from fittings and surfaces. Rinse thoroughly after cleaning and polish with a soft dry cloth to restore original luster of material.

Notice:

Do not use cleaners in tanks. Products containing chlorine (calcium hypochlorite) can seriously damage fittings. This damage can cause leakage and property damage.

LIXIL VIETNAM Public Company Limited shall not be responsible or liable for any tank fitting damage caused by the use of cleaners containing chlorine (calcium hypochlorite).

LIXIL VIETNAM PUBLIC COMPANY LIMITED WARRANTY

If inspection of this product, within one year warranty after purchasing, confirms that its defective of a similar model under normal use in material or workmanship. We will repair or, at its option exchange the product.

The warranty does not cover the following:

- 1.No documentary evidences to show the period of warranty such sas receipt, warranty card.
- 2.Consequential or incidental damages.
- 3.Defects or damages arising from shipping, installation, alternation, accidents, misuse or lack of proper maintenance.
4. Postage or shipping costs incurred in returning products for repair or replacement under this warranty and any labor or other costs or removal or installation of products under this warranty.
5. Discontinued products.

LIXIL VIET NAM CORPORATION

Address: Yen Binh Hamlet, Duong Xa, Gia Lam,
Ha Noi, Viet Nam
Website: www.americanstandard.com.vn



LIXIL CUSTOMER CARE

American Standard

 **INAX**

 **TOSTEM**